



How to access WEX data on your iPhone

These instructions will walk through logging into your Google account on your mobile device for the first time.

[[Click here](#) for a Portuguese translation of this document.]

1. Open the App Store* and download the Gmail mobile app.

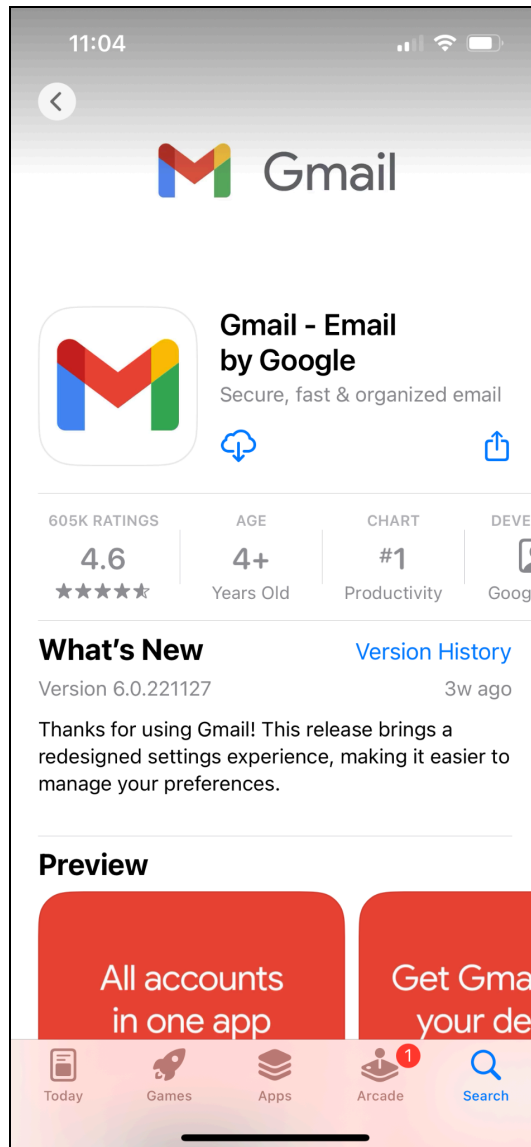

**If you are using a brand new Apple ID for the first time on a company owned iPhone and you are prompted to "verify your ID" (see below), [please contact the Service Desk](#) for assistance.*

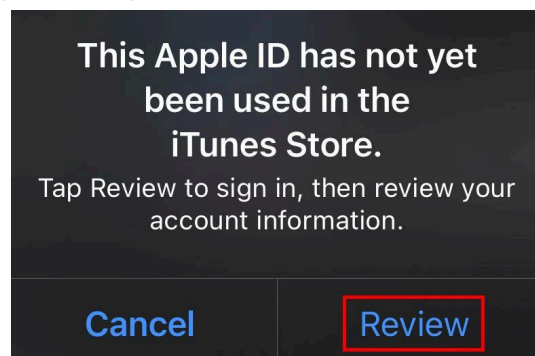

2. Open the Gmail app and sign in with your WEX account.

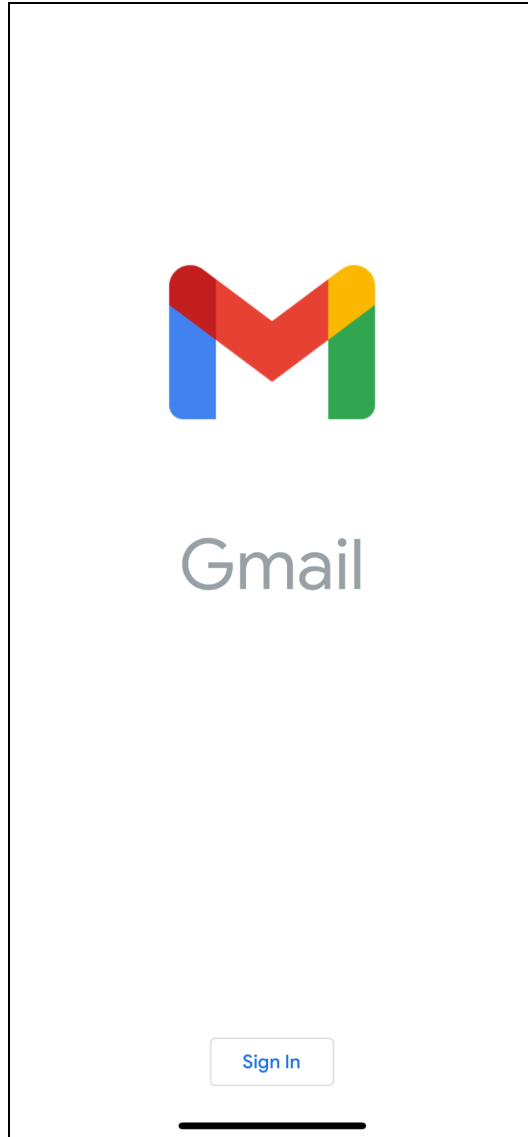

3. Upon signing in with your WEX account, you will be prompted to “Install the latest version of ‘Google Device Policy’ so you can access your work data.” Accept this notification by clicking on “**APP STORE**”

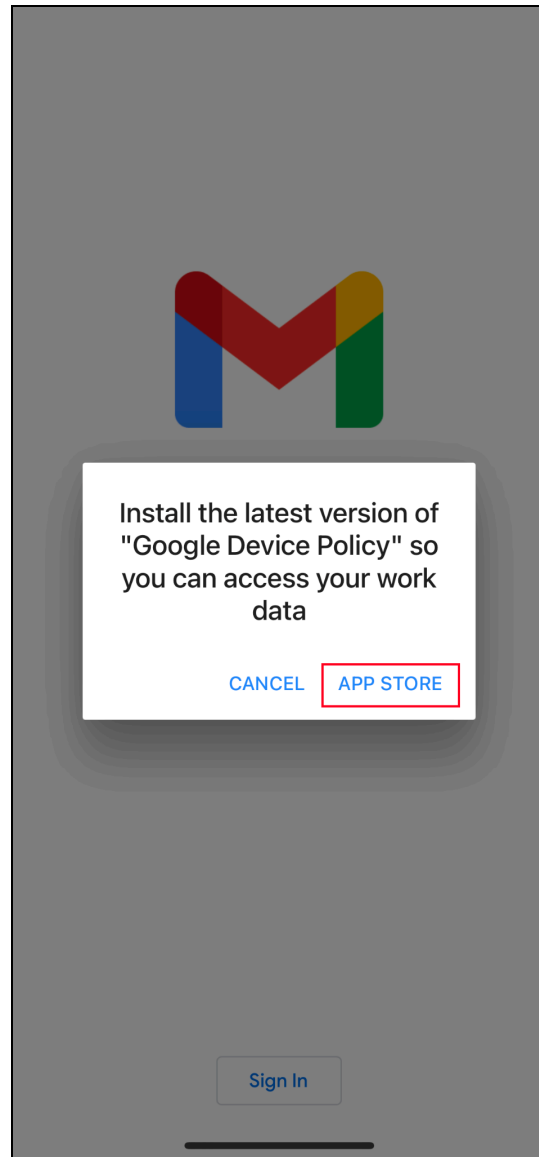

4. This will redirect you to the App Store listing for “Google Device Policy” by Google LLC. **Download this application:**

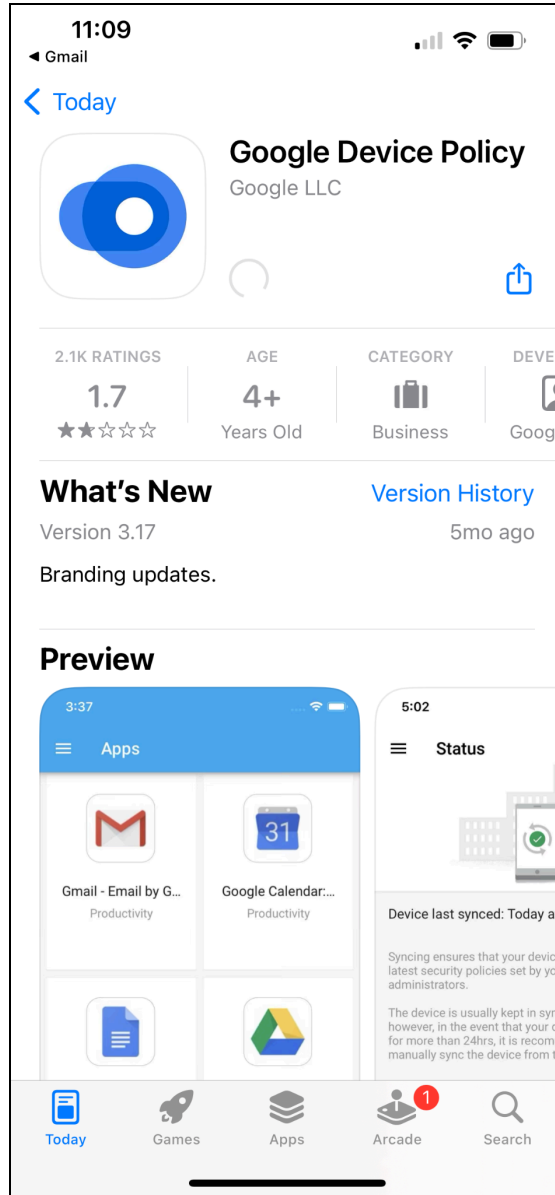

5. Open the Google Device Policy app and swipe right to read through the introduction screens that explain the use of this application:



6. In the last introduction screen, click **Continue**:

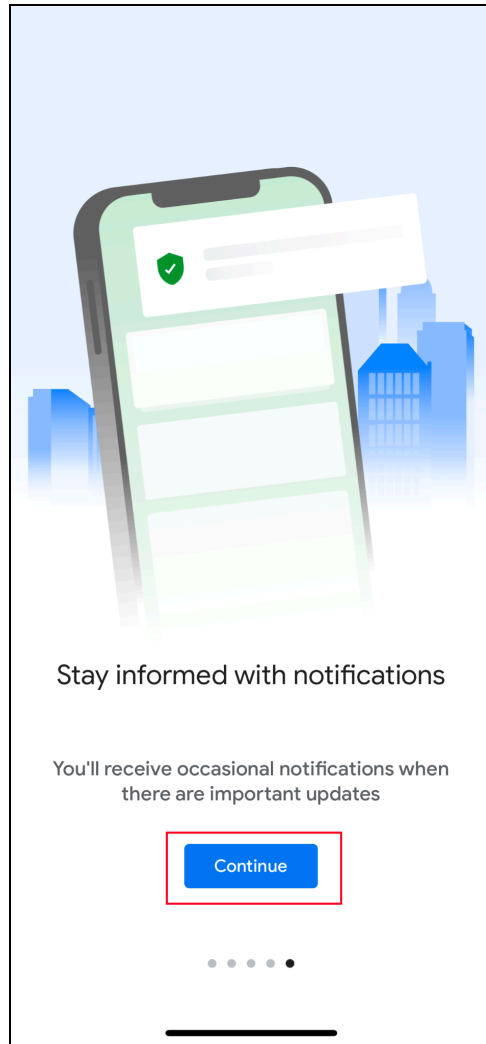

7. You will be prompted to allow Google Device Policy to send you notifications, click **Allow**:

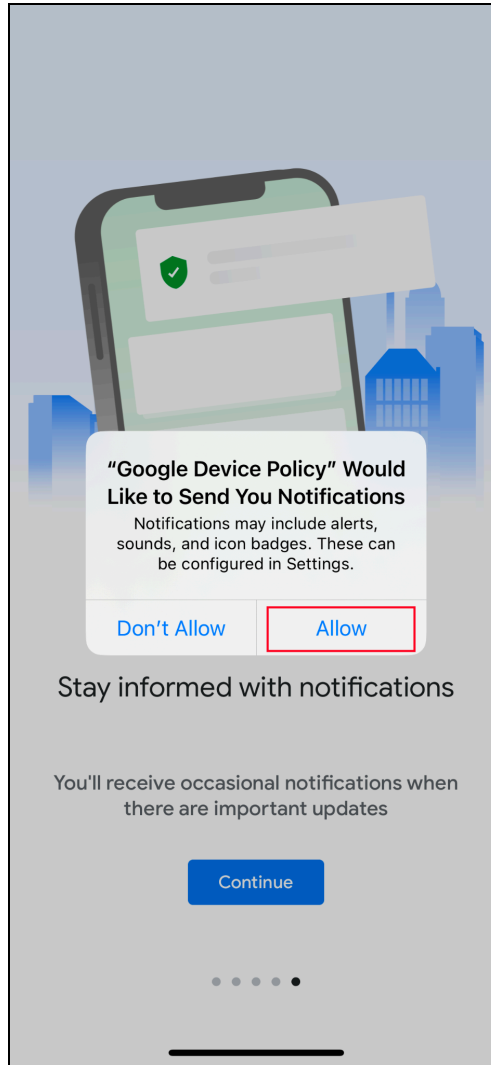

8. You will see confirmation that “You’re all set” and that notifications are on. Click **Get started**:

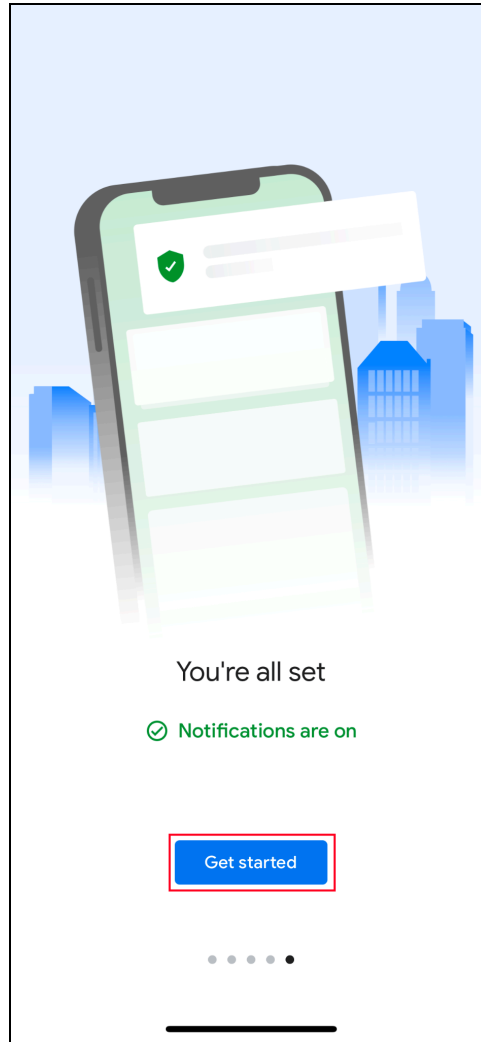

9. You may have the option to select your WEX account. If you don't have that option, go ahead and add your WEX account by clicking **"Add another account."**

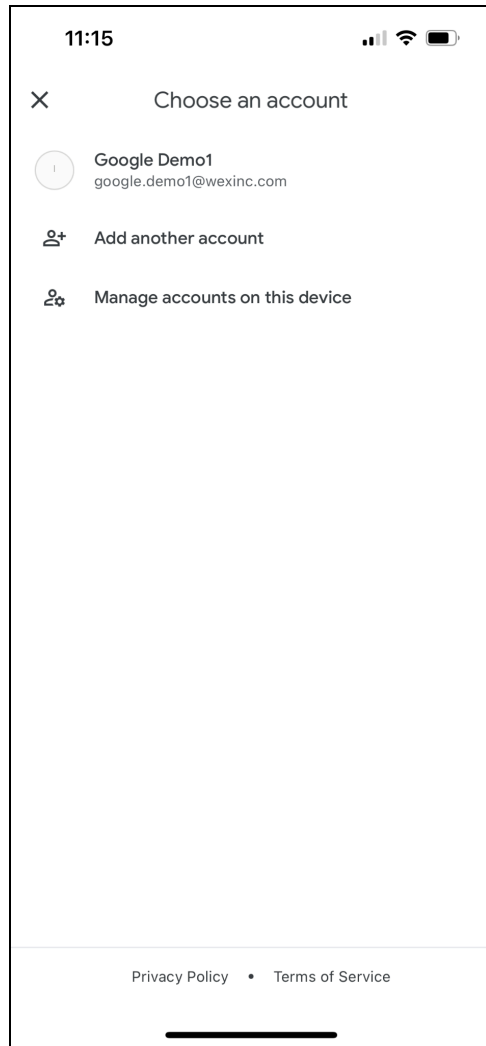

10. Accept the Terms of Service:

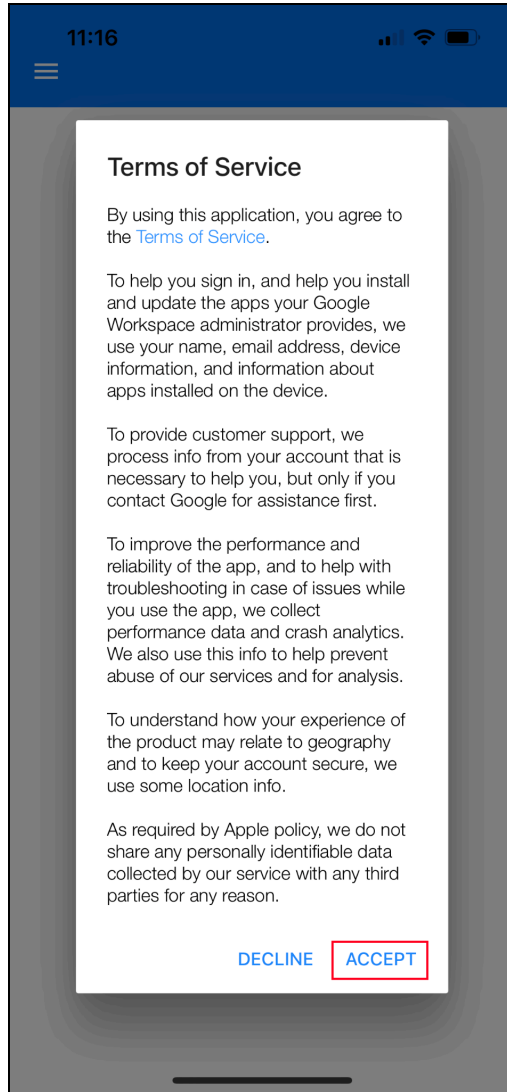

11. You will then be prompted to install the configuration profile onto your device. Click on the **download button** on this screen:

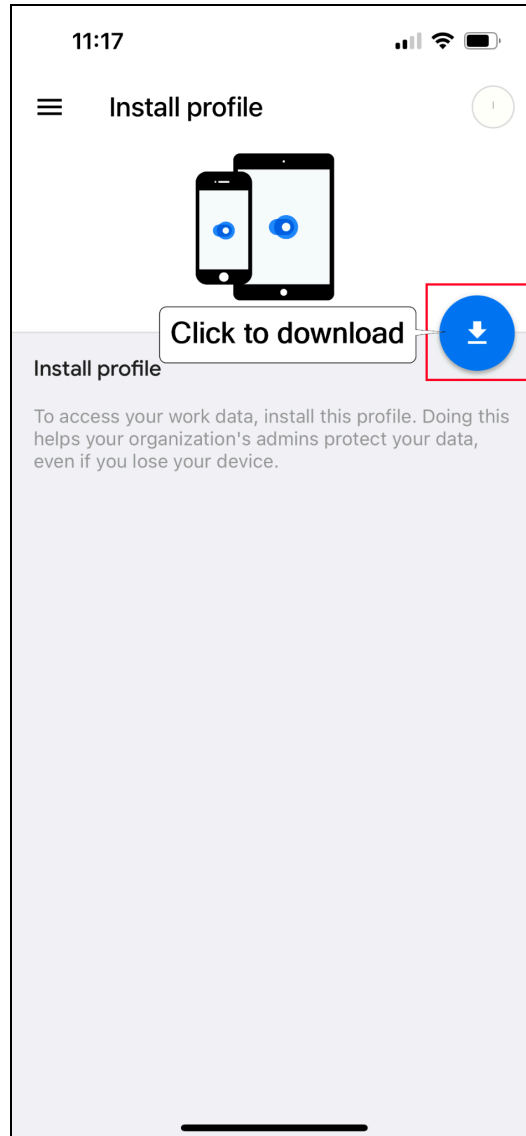

12. You will receive a warning that the website is downloading a configuration profile. Click **Allow***:

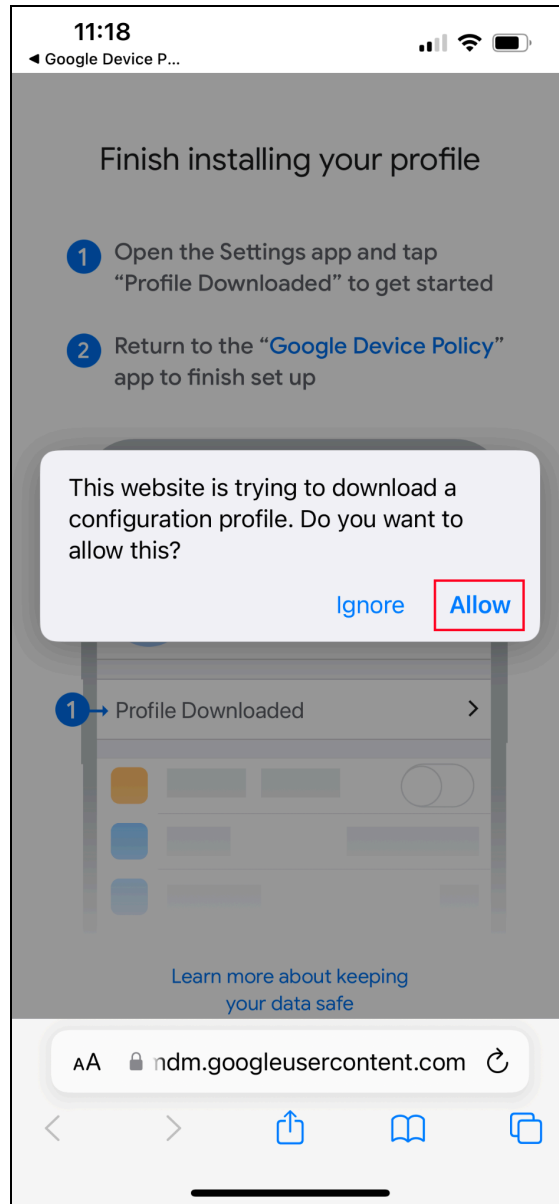

**Please note: if your phone's default browser is set to Chrome and this page opens in Chrome, you will be redirected to open it in Safari instead.*

13. You will receive confirmation that the profile has been downloaded.
Click **Close**:

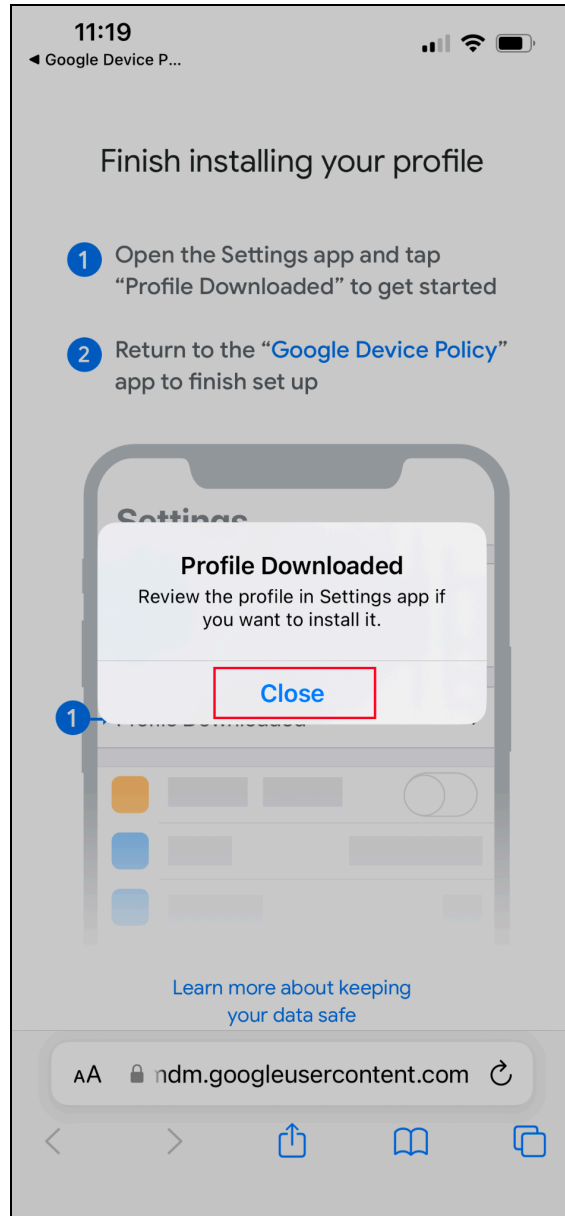

14. To finish installing the configuration profile, close this window, open your phone's settings, and click on **Profile Downloaded** to finish the installation:

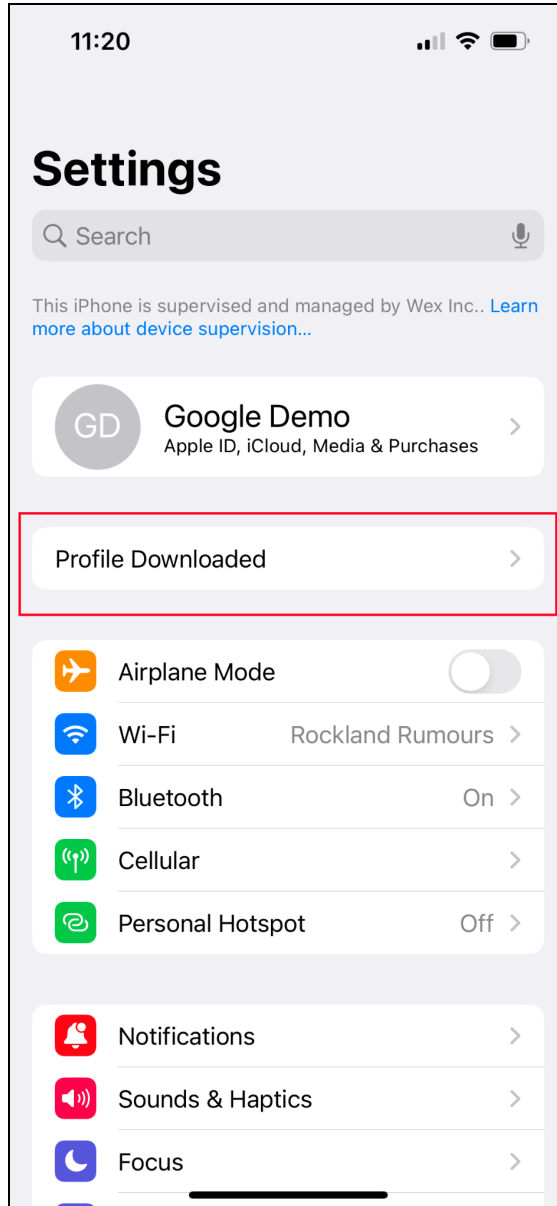

15. You will be prompted to install the **Google Apps Device Policy Profile**. Click **Install** in the top right corner:

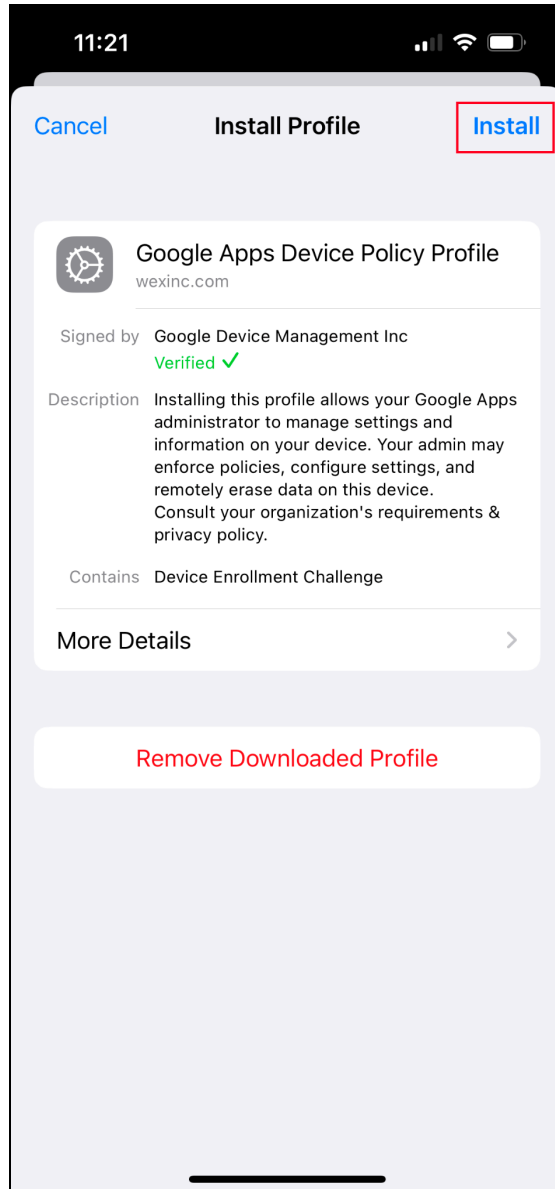

16. Enter your phone's passcode to confirm installation:

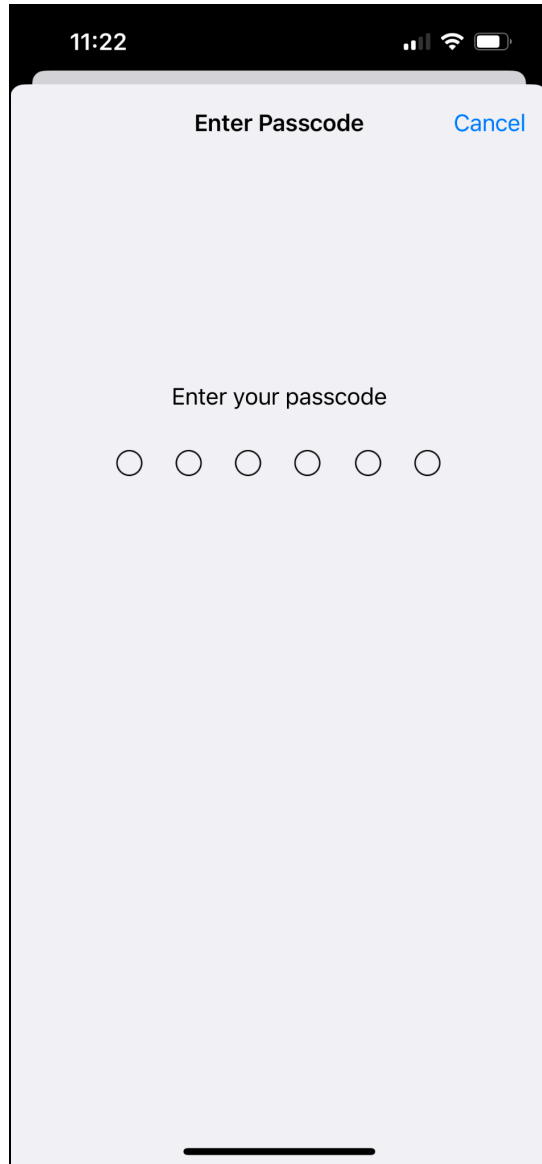

17. Click Install:

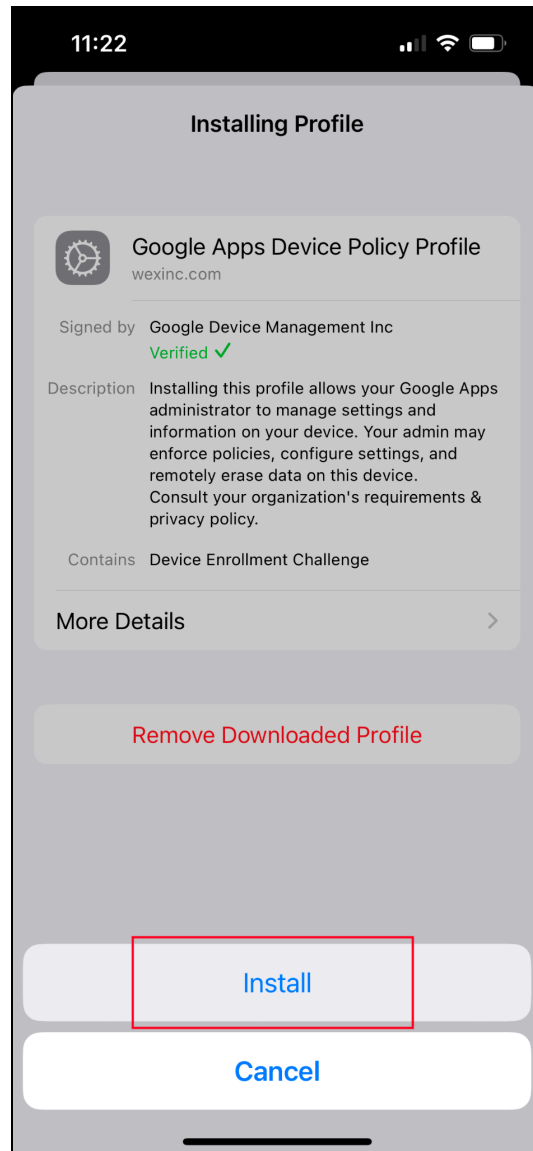

18. You will receive a warning message. This message is just letting you know that WEX will have control over your device. This is necessary to wipe your device in the event it is lost or stolen. *WEX will not have access to view any data, it will only have the ability to remove access to WEX related data.* Click **Install** in the top right corner:

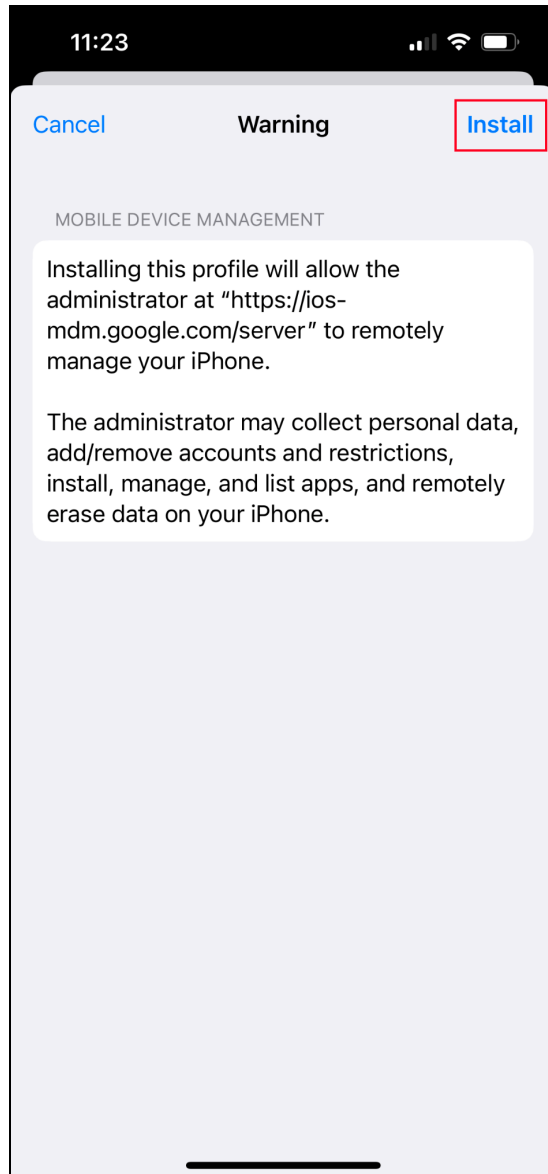

19. A Remote Management screen will pop up asking you if you trust the source. Click **Trust** to proceed:

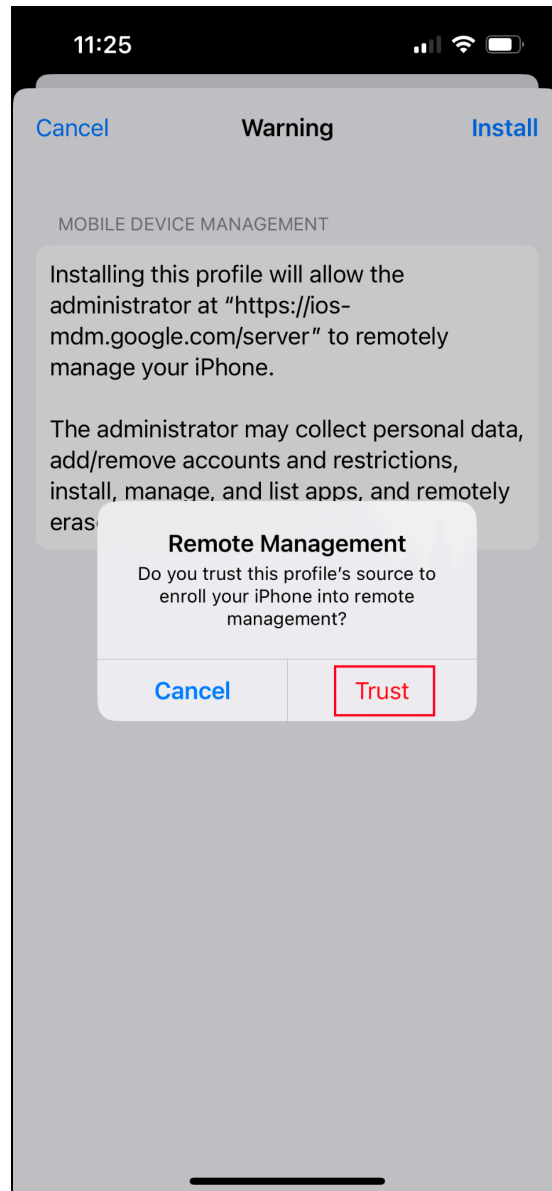

20. You will see confirmation that the Profile has been installed. Click **Done:**

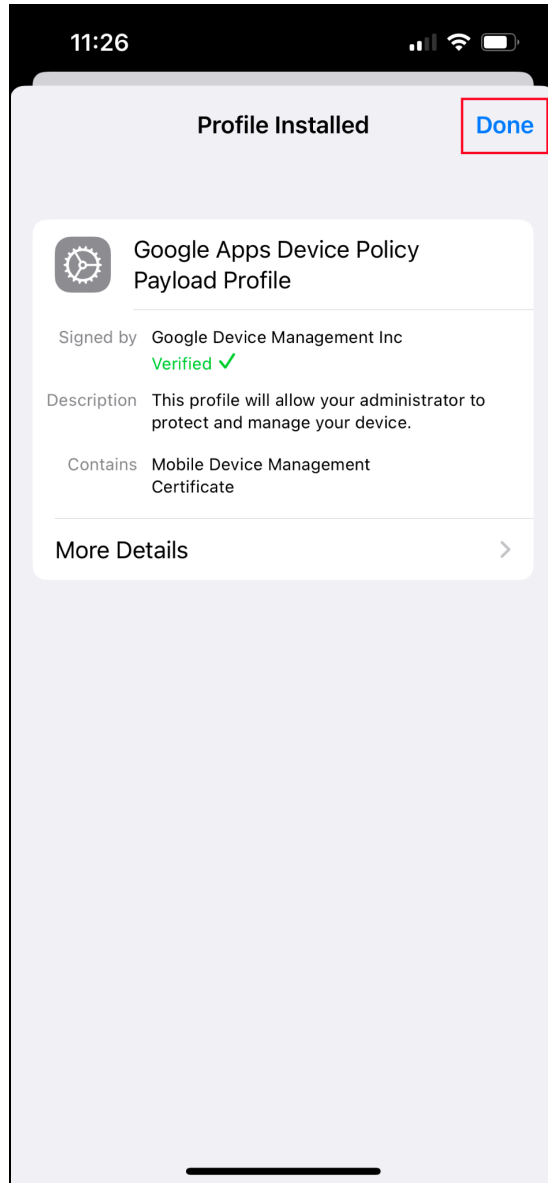

21. You may now access WEX data via Google's mobile apps. *Moving forward, to install WEX related applications, you must open the Google Device Policy app, click on the 3 horizontal lines (burger button) in the top left corner, and select Apps, and install the applications from there:*

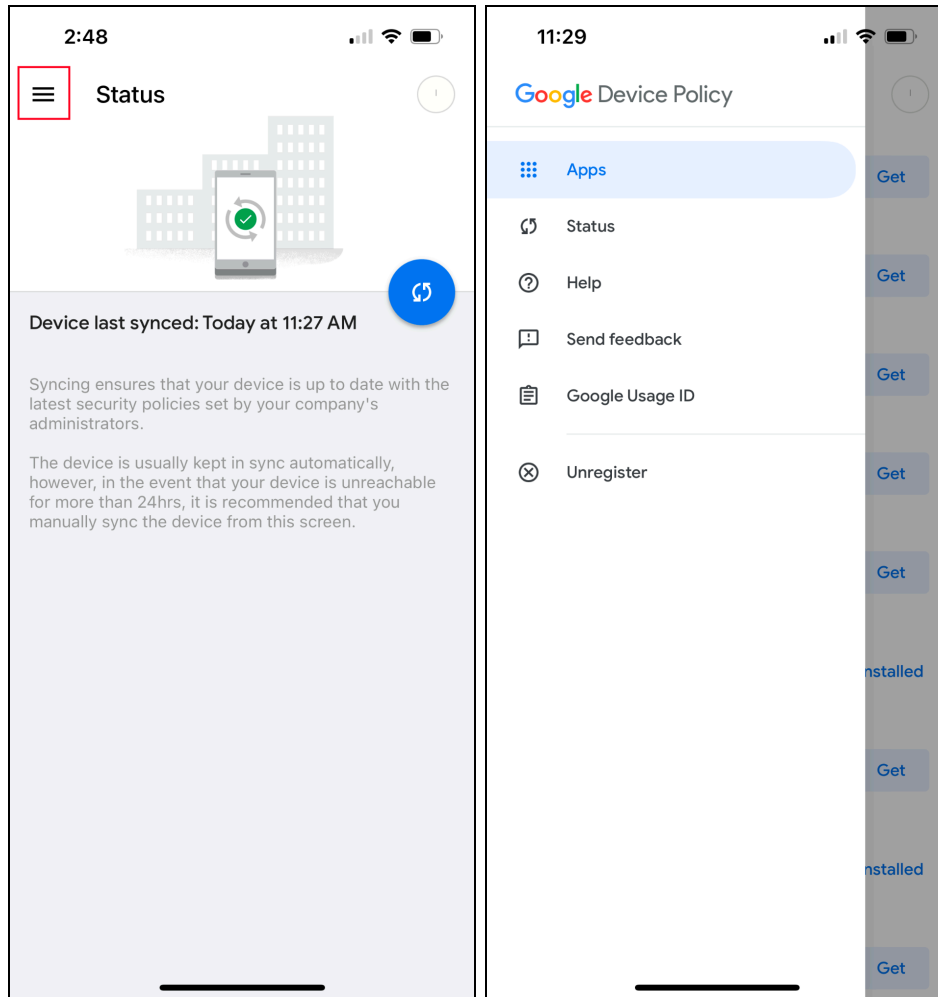

22. You can easily install all WEX related apps from this screen by clicking “**Get**” to the right of each app. At a minimum, you will want to install **Gmail - Email by Google**, **Google Calendar: Get Organized**, and **Google Drive**:

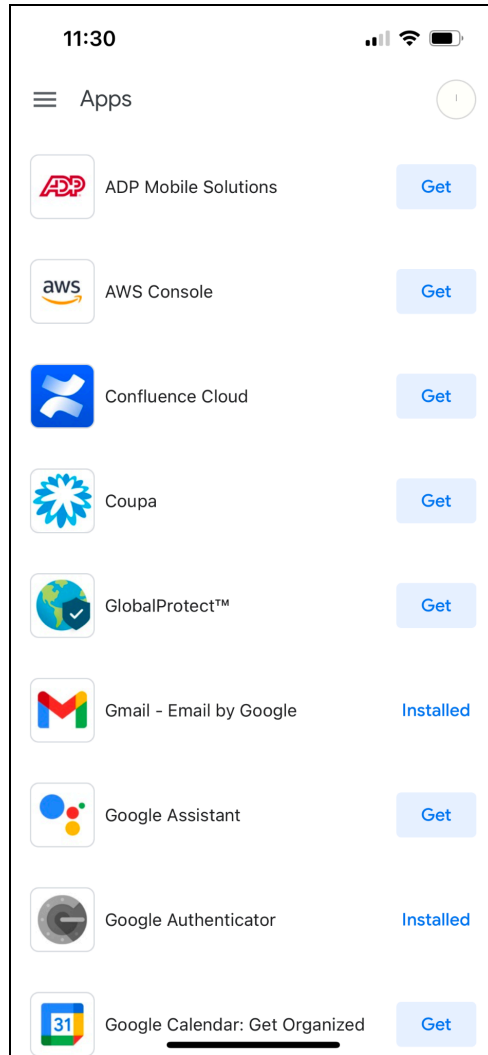

To access your WEX data, download the Google apps and login with your WEX account. If you have any questions or concerns, please [contact the service desk](#) for assistance.

**You are now finished setting up Google MDM.
You are free to access all of your Google
applications.**

